



SEMI-FLUSH MOUNT



QUESTIONS OR CONCERNS CONTACT CANARM AT:

1-800-265-1833 (English) / 1-800-567-2513 (French)

Monday through Friday 8:00 AM to 5:00 PM E.S.T.

ISF919A03313
01/10



TOOLS AND MATERIALS REQUIRED:



Wiring supplies
as required by
the Canadian
Electrical Code
and/or the
Quebec
Electrical code

SAFETY PRECAUTIONS:

1. TURN OFF ELECTRICAL POWER BEFORE STARTING INSTALLATION OF LIGHT FIXTURE.
2. THIS PRODUCT MUST BE INSTALLED IN ACCORDANCE WITH THE APPLICABLE INSTALLATION CODE BY A PERSON FAMILIAR WITH THE CONSTRUCTION AND OPERATION OF THE PRODUCT AND THE HAZARDS INVOLVED.
3. CONNECT THE GROUND WIRE (BARE COPPER OR GREEN) FROM YOUR FIXTURE TO THE GROUND WIRE (BARE COPPER OR GREEN) OR GROUND SCREW IN THE ELECTRICAL OUTLET BOX.
4. NOT FOR USE IN LUMINAIRES CONTROLLED BY A DIMMER.
5. THIS LAMP CONTAINS MERCURY. FOR DISPOSAL LAW, SEE www.lamprecycle.org.

INSTALLATION:

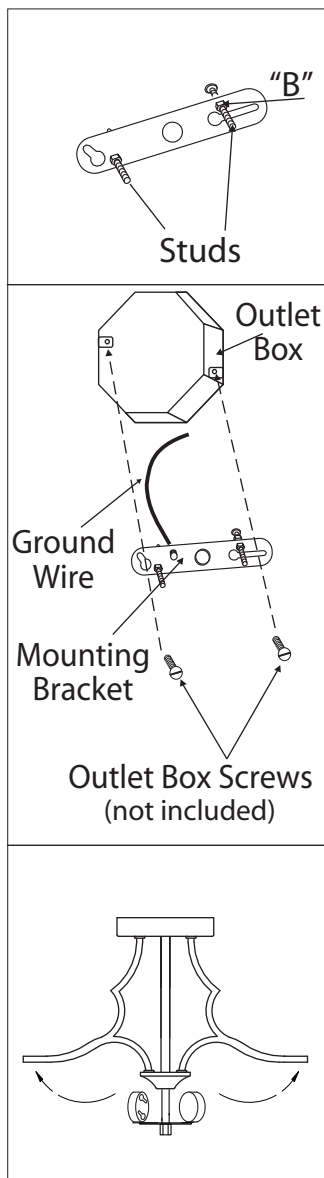

1. Loosen "B". Adjust stud to desired length and lock in place with "B".

2. Mount the mounting bracket to outlet box using outlet box screws (not included). Make sure the studs or nipple on the mounting bracket are facing out from the outlet box.

3. Spread the arms evenly.

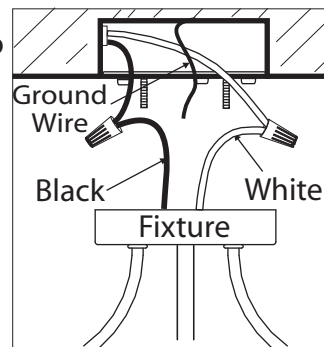

4. Connect the ground wire (bare copper or green) from your fixture to the ground wire (bare copper or green) or ground screw in the electrical outlet box. Connect black wire from fixture to black wire in outlet box and connect the white wire from fixture to white wire in outlet box.

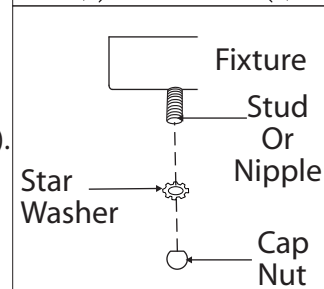

5. Tuck electrical wires into outlet box and position fixture over studs or nipple on mounting bracket assembly. Secure fixture in place with star washers and cap nuts.

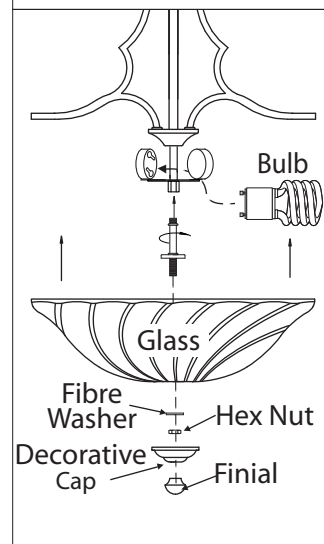

6. Attach the stem to the fixture and position the glass over the stem. Secure the glass in place using the fibre washer, hex nut, decorative cap and finial.

7. Install proper bulb type and wattage.